



Interactive Kiosk™

Deliver the ideal experience with the ultra-intuitive and highly-modular iOS-based platform for enterprise innovation.

Enterprise Ready

- Secure and durable commercial-grade design for reliable high-volume use
- Performance monitoring and real-time diagnostics to prevent service disruptions
- Power Hub for integrated power management to iPad and peripherals

Unmatched Performance

- 45 1D/2D symbologies with Aila's image-based TrueScan™ technology
- 10x resolution vs. traditional scan engines deliver a superior user experience
- 4x CPU performance vs. enterprise Android devices

Ultra-Flexible

- Easy to deploy, install and upgrade with Aila's ultra-modular design that grows with your business
- Extend capabilities with mPOS, printers, peripherals and ID capture
- Fits seamlessly into any enterprise environment with versatile mounting options



Interactive Kiosk at a Glance

Intuitive, modular and ahead of its time, Aila's Interactive Kiosk opens the door to new and innovative ways to engage with the modern consumer. Integrate quickly, scale with ease, and deliver effortless scanning performance, enabling a truly seamless experience every time.

BUILT FOR iOS

Engineered exclusively for iOS—the most versatile, secure, and familiar operating system—Aila's products meet the demands of the modern enterprise without the cost or bulk of legacy systems.

AILA'S PLATFORM CAPABILITIES

Develop. Deploy. Scale. Enable endless opportunities with our robust partner ecosystem, suite of developer tools and advanced image-based scanning technology.



INTERACTIVE KIOSK SPECIFICATIONS

KIOSK OPTIONS

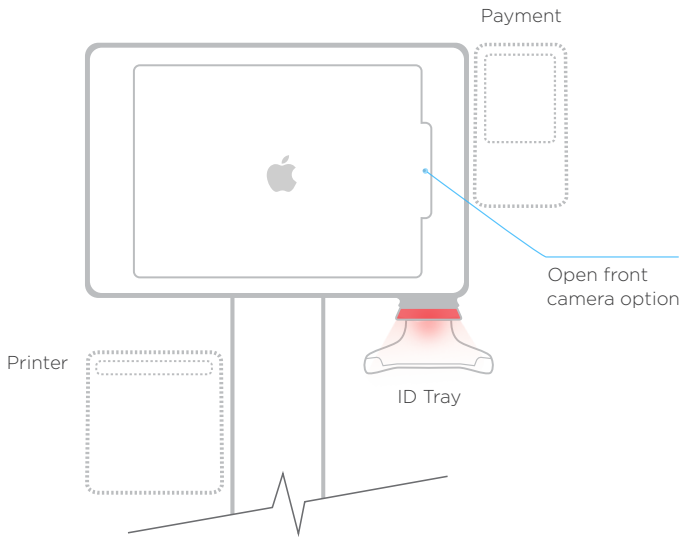

COMPATIBILITY & DIMENSIONS

10.2" iPad (7th Gen.)	8.1" x 11.8" x 2.0"
12.9" iPad Pro (3rd Gen.)	9.3" x 12.9" x 1.9"

PERFORMANCE

Advanced image-based scanning enhances speed and accuracy

SCANNING SPEED:	<50 ms continuous mode
SCANNING RANGE:	2-16"
FIELD OF VIEW:	49H° X 33V°
AIMING & ILLUMINATION:	LED red-dot aimer and broad spectrum illumination

USB-C POWER DELIVERY

10.2" iPad (7th Gen.)	15W at 5/9/15V
12.9" iPad Pro (3rd Gen.)	18W at 9/12/15V

SDK COMPATIBILITY

Native iOS; Cordova; Xamarin; React Native

MOUNTING OPTIONS

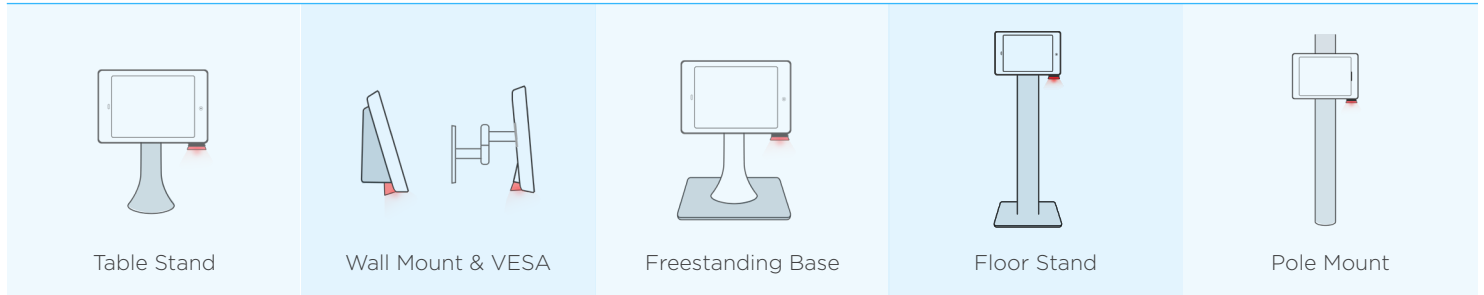

SYMBOLOGIES

Codabar, Code 39, Code 93, Code 128, Interleaved 2 of 5, GS1 DataBar, PDF417, QR Code, UPC/EAN/JAN

ADVANCED SYMBOLOGIES

20+ more symbologies available with additional licensing, including Aztec Code, Data Matrix, GS1 Composite, MaxiCode, Micro PDF, Micro QR and more

PROCESSOR

ARM™ Cortex-M series

ACCESSORIES & CUSTOMIZATIONS

ACCESSORIES: ID Tray, POS Cradles, Printer Braces, Quick Disconnect
 FACE PLATE COLORS: ● ● ● ● ● ○ (Black & gray standard)

SECURITY & DURABILITY

Button access key fob and barrel lock key

COMPLIANCE

FCC, EMI, RoHS, CE

ENVIRONMENT

OPERATING:	0° - 35°C (32° - 95°F)
STORAGE:	-20° - 45° C (-4° - 113°F)

SOLUTIONS

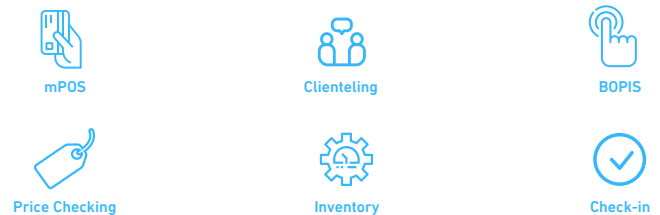

INDUSTRIES WE SERVE

